

Gate Valve

COBRA-SGP/SGO/SGF

PN 16/25
DN 25-600
Elastomer-coated Wedge
Bolted Bonnet
Flanged or Threaded Ends

Type Series Booklet



Legal information/Copyright

Type Series Booklet COBRA-SGP/SGO/SGF

KSB Aktiengesellschaft

All rights reserved. The contents provided herein must neither be distributed, copied, reproduced, edited or processed for any other purpose, nor otherwise transmitted, published or made available to a third party without KSB's express written consent.

Subject to technical modification without prior notice.

© KSB Aktiengesellschaft Frankenthal 2013

Gate Valves

Gate Valves with Bolted Bonnet

COBRA-SGP/SGO/SGF



Main applications

- Irrigation systems
- Pressure boosting
- Domestic water supply
- Sewage treatment plants
- Air-conditioning systems
- Cooling circuits
- Water treatment
- Water supply systems
- Food and beverages industry

Fluids handled

- Cooling water
- Drinking water
- Fluids containing mineral oils
- Oil
- River, lake and groundwater
- Service water
- Waste water

Operating data

Operating properties

Characteristic	Value
Nominal pressure	PN 16/25
Nominal size	DN 25-600
Max. permissible pressure	25 bar
Max. permissible temperature	70 °C

Selection as per pressure/temperature ratings (⇒ Page 4)

Body materials

Overview of available materials

Material	Material number	Temperature limit
EN-GJS-400-15	EN-JS1030	+70 °C

Design details

Design

- Gate valve to UNI EN 1171
- COBRA-SGP with flat body
- COBRA-SGO with oval body
- COBRA-SGF with threaded ends to ISO 7/1
- COBRA-SGP BS drilled and dimensioned to BS 4504
- Bolted bonnet
- Internal stem thread
- Rotating stem
- Elastomer-coated wedge (NBR)
- Non-toxic elastomer
- Drain plug
- Valve certified for drinking water applications to D.M. 174/2004, WRAS (elastomer and coating) and ACS
- Corrosion protection: electrostatic epoxy resin coating inside and outside; thickness of epoxy coating: 250 µm.

Variants

- Gearboxes
- Electric actuators
- Cap
- Accessories for underground installation
- COBRA-SGF HT (high-temperature applications up to 120 °C)
- EPDM-coated wedge on request.
- Thickness of epoxy coating: 300 µm

Product benefits

- Valve easy to inspect and drain via standard drain plug.
- Approved for drinking water applications due to electrostatic epoxy resin coating
- Pressure drop reduced by hydraulically favourable flow passage of compact valve body without dead volumes.

Related documents

- Operating manual V939011/1.10

On all enquiries / orders please specify

1. Type
2. Nominal pressure
3. Nominal size
4. Variants
5. Number of type series booklet

Pressure/temperature ratings

Permissible operating pressures in bar at temperatures in °C

Nominal pressure	Nominal size	Permissible operating pressures ¹⁾
PN	DN	Up to +70 °C
16	25-600	16,0
25	25-300	25,0

Materials

COBRA-SGP

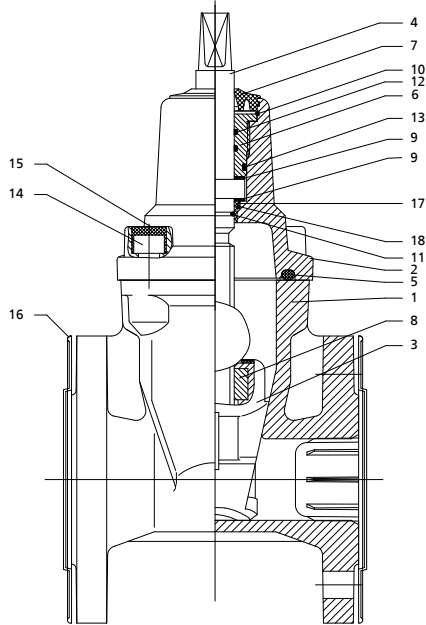

COBRA-SGO

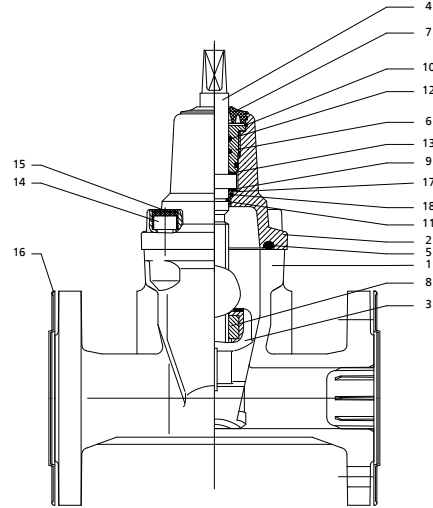

COBRA-SGF

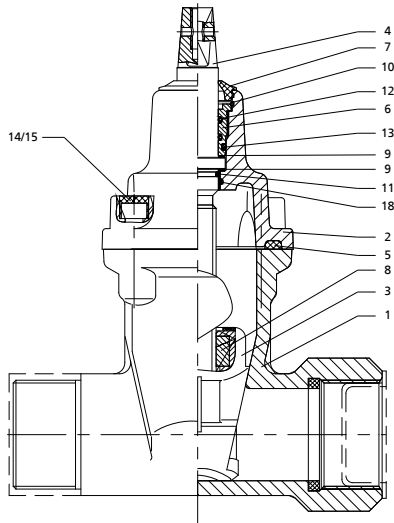

¹⁾ Static load

Overview of available materials

Part No.	Description	Material	Material number	Note
1	Body	EN-GJS-400-15	EN-JS1030	Epoxy-coated
2	Bonnet	EN-GJS-400-15	EN-JS1030	Epoxy-coated
3	Wedge	EN-GJS-400-15	EN-JS1030	Elastomer-coated (NBR/EPDM)
4	Stem	X20Cr13	1.4021	
5	Bonnet gasket	EPDM		
6	Threaded bush	MO59		
7	Plug	EPDM		
8	Stem nut	X5CrNiMo17-12-2	1.4401	
9	Stem washer	Tarnamid	T-27	
10	Circlip	65G		
11	O-ring	EPDM		
12		EPDM		
13		EPDM		
14	Screw	Galvanised steel	Fe/Zn5	
15	Screw cover	Paraffin		
16	Cap	Polypropylene		
17	Stem sleeve	Tarnamid	T-27	
18	O-ring	EPDM		

Dimensions

Dimensions of COBRA-SGP

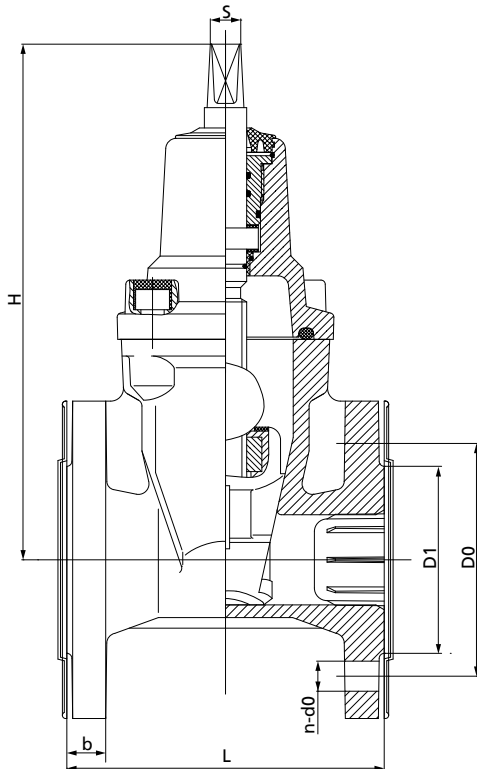

Dimensions in mm

PN	DN	L	H	S	n-d0	b	D1	D0	[kg]
16	40	140	231	14	4-18	19,0	88	110	9,3
	50	150	241	14	4-18	19,0	102	125	11,2
	65	170	283	17	4-18	19,0	122	145	15,8
	80	180	307	17	8-18	19,0	138	160	19,5
	100	190	346	19	8-18	19,0	158	180	25,8
	125	200	385	19	8-18	19,0	188	210	32,2
	150	210	457	19	8-22	19,0	212	240	46,3
	200	230	534	24	12-22	20,0	268	295	65,3
	250	250	633	27	12-26	22,0	320	355	94,0
	300	270	708	27	12-26	24,5	378	410	130,0
	350	290	790	27	12-28	32,0	429	470	200,0
25	40	140	231	14	4-18	19,0	88	110	9,3
	50	150	241	14	4-18	19,0	102	125	11,2
	65	170	283	17	8-18	19,0	122	145	15,8
	80	180	307	17	8-18	19,0	138	160	19,5
	100	190	346	19	8-22	19,0	158	190	25,8
	125	200	385	19	8-26	19,0	188	220	32,2
	150	210	457	19	8-26	20,0	212	250	46,3
	200	230	534	24	12-26	22,0	274	310	65,3
	250	250	633	27	12-30	24,5	330	370	94,0
	300	270	708	27	16-30	27,5	389	430	130,0

Mating dimensions - Standards

Face-to-face lengths: EN 558-1/14
Flanges: DIN EN 1092-2

Dimensions of COBRA-SGO

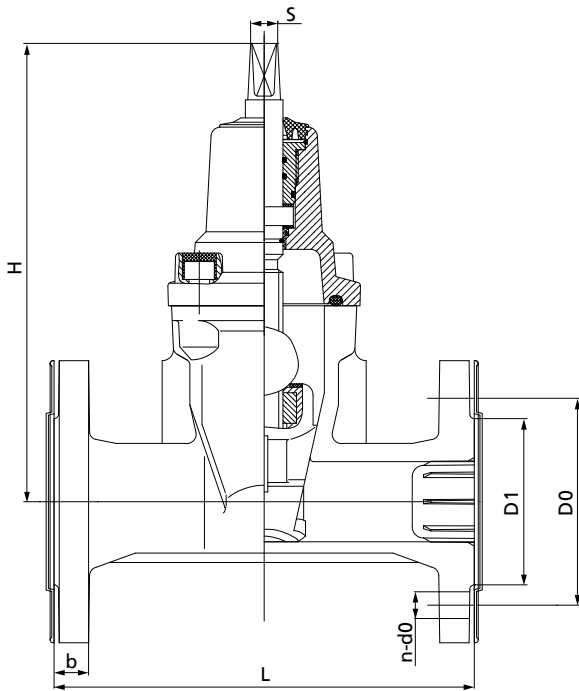

Dimensions in mm

PN	DN	L	H	S	n-d0	b	D1	D0	[kg]
16	40	240	231	14	4-18	19,0	88	110	10,7
	50	250	241	14	4-18	19,0	102	125	12,6
	65	270	283	17	4-18	19,0	122	145	21,2
	80	280	307	17	8-18	19,0	138	160	24,9
	100	300	346	19	8-18	19,0	158	180	29,9
	125	325	385	19	8-18	19,0	188	210	36,7
	150	350	457	19	8-22	19,0	212	240	51,2
	200	400	534	24	12-22	20,0	268	295	81,4
	250	450	633	27	12-26	22,0	320	355	100,0
	300	500	708	27	12-26	24,5	378	410	150,0
	350	550	790	27	12-28	32,0	429	470	232,0
	400	600	1020	32	12-30	32,0	480	525	330,0
25	40	240	231	14	4-18	19,0	88	110	10,7
	50	250	241	14	4-18	19,0	102	125	12,6
	65	270	283	17	8-18	19,0	122	145	21,2
	80	280	307	17	8-18	19,0	138	160	24,9
	100	300	346	19	8-22	19,0	158	190	29,9
	125	325	385	19	8-26	19,0	188	220	36,7
	150	350	457	19	8-26	20,0	212	250	51,2
	200	400	534	24	12-26	22,0	274	310	81,4
	250	450	633	27	12-30	24,5	330	370	100,0
	300	500	708	27	16-30	27,5	389	430	150,0

Mating dimensions - Standards

Face-to-face lengths: EN 558-1/15
Flanges: DIN EN 1092-2

Dimensions of COBRA-SGF

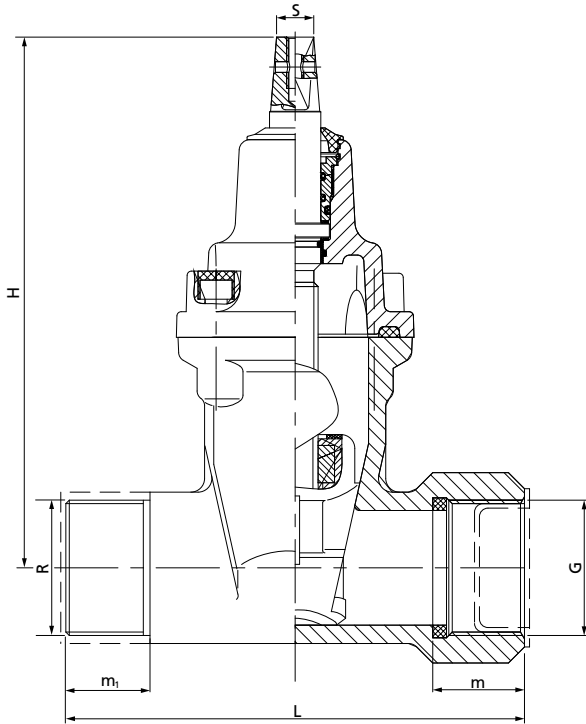

Dimensions in mm

PN	DN	G/R	L	m	m ₁	H	S	[kg]
16	25	1"/1"	105	25	25	145	12	2,3
	32	5/4"/6/4"	120	25	25	145	12	2,8
		5/4"/2"	130	25	25	145	12	2,8
	40	6/4"/6/4"	180	25	40	230	14	6,5
		6/4"/2"	180	25	40	230	14	6,5
	50	2"/2"	200	25	40	240	14	7,7

Mating dimensions - Standards

Face-to-face lengths: see table
Threaded ends: ISO 7/1

Notes on installation

Horizontal installation recommended; vertical installation permitted. Horizontal installation with handwheel below is not recommended.



KSB Italia S.p.A.

Via Massimo D'Azeglio, 32

20049 Concorezzo MB

Tel. +39 039 6048-000 – Fax +39 039 6048-097

www.ksb.com

Centri Service

Concorezzo MB • Via Massimo D'Azeglio, 32

Tel. +39 039 6048-000 • Fax +39 039 6048-882

Scorzè VE • Via Guido Rossa, 12/A

Tel. +39 041 5840917 • Fax +39 041 5840918